

**PLASMA CUTTING TORCH**  
**SC80 PLASMA TORCH & SPARES**

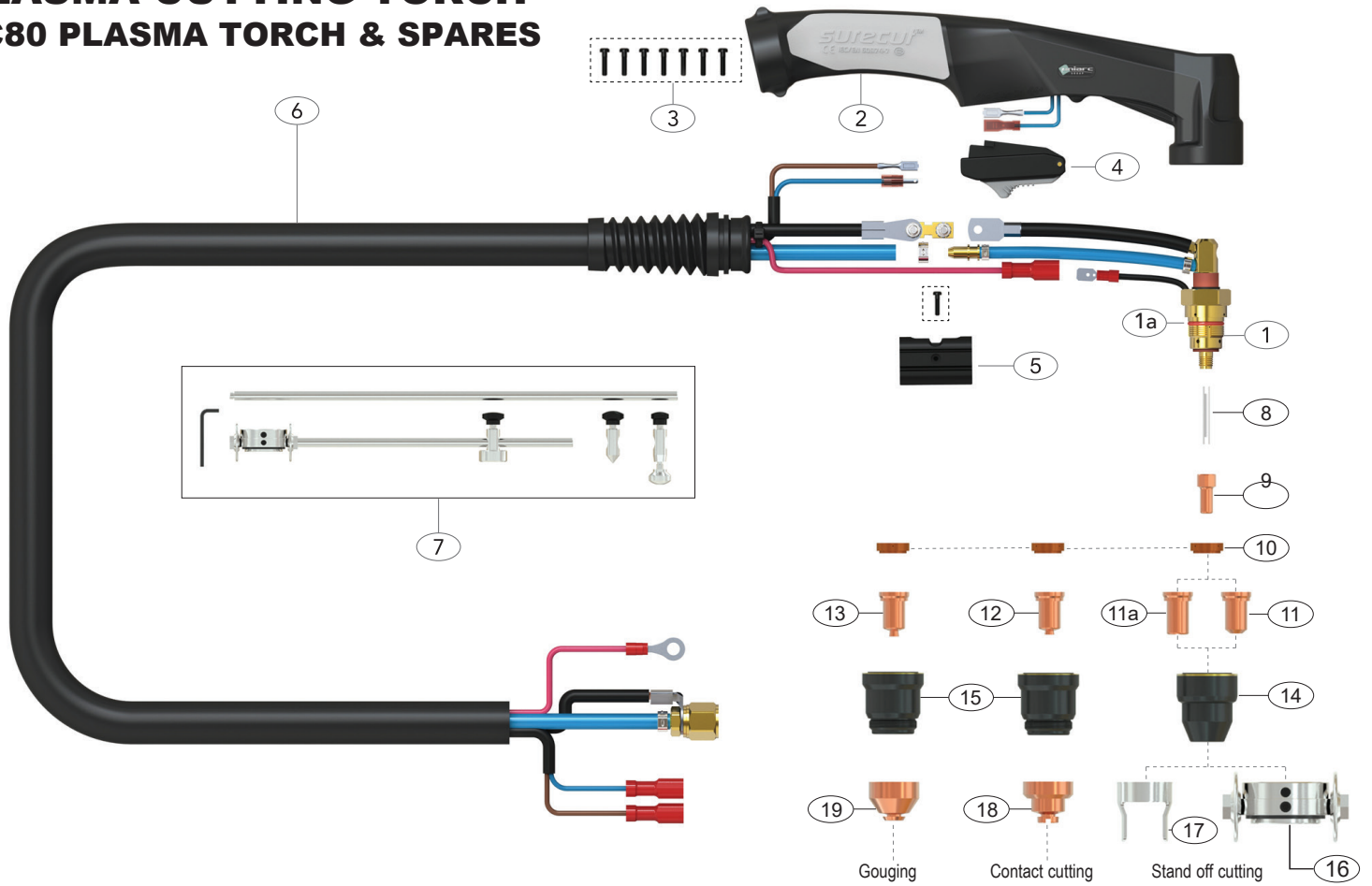

**Technical Data**

Max Current	80A	Gas Pressure	4.5-5.0 Bar (65-75psi)
Duty Cycle	60%	Gas Flow	110 l/min
Gas	Air/N		with Pilot Arc

**Spare Parts**

#	Part Number	Description
	SC80-60-CC1	Surecut 80 Plasma Torch x 6m
	SCM80R-60-CC1	Surecut 80 Machine Torch x 6m
1	SC8001	SC80 70 Torch Head Kit
2	SC8014	Plasma Handle Kit
3	SCSP1	Screw Pack
4	SC2516	Plasma Safety Trigger
5	SC8015	Location Block
6	SC8019-60-CF4	Cable Assembly Complete x 6mt
7	SC8050	Circle Cutting Attachment Kit
8	SC8002	Cooling Tube
9	SC8004	Electrode
10	SC8006	Swirl Ring
11	SC8020-10	Cutting Tip 1.0mm

**Spare Parts**

#	Part Number	Description
	SC8020-13	Cutting Tip 1.3mm
11a	SC8022-09	Cutting Tip 0.9mm Cross Groove
12	SC8026-10	Contact Cutting Tip 1.0 mm, 40-50A
	SC8026-11	Contact Cutting Tip 1.1 mm, 50-60A
	SC8026-12	Contact Cutting Tip 1.2 mm, 60-70A
	SC8026-13	Contact Cutting Tip 1.3 mm, 70-80A
13	SC8028-16	SC80 Gouging Tip 1.6mm
14	SC8030	Retaining Cap
15	SC8031	Shield Cap Body
16	SC8051	SC80 Cutting Buggy
17	SC8040	SC80 Stand Off Guide
18	SC8041	Contact Cutting Shield Cap
19	SC8043	Gouging Shield Cap